

COLLARI
PIPE CLAMPS

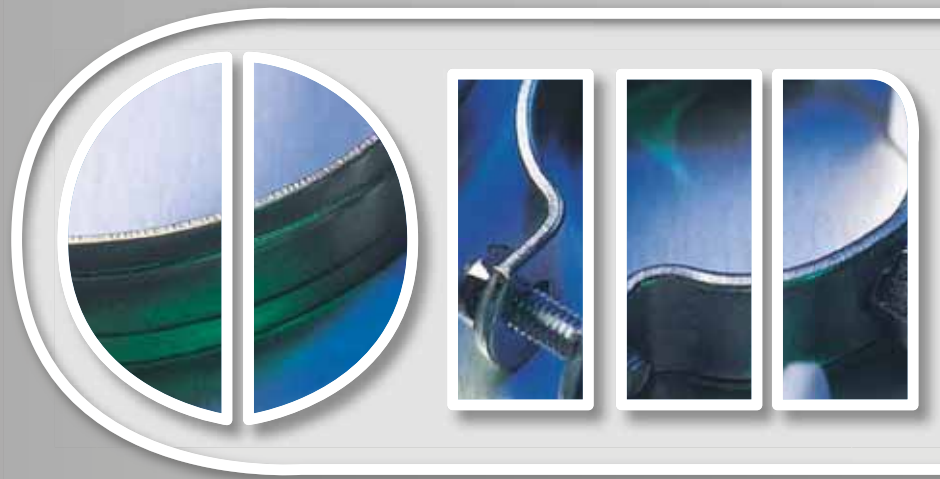

omec

Art. 120

COLLARINO SINGOLO IN NYLON PER TUBO IN RAME
SINGLE COPPER PIPE CLAMP IN POLYAMMIDE

M Nylon

 Bianco

 Resistenza ai raggi ultravioletti

 - 40° + 80°

 Buste PLT:
10 collari, 10 viti

 Scatole di cartone

CODE	CONF.	MISURA Ø mm	VITE Ø mm	€
120C1000	100	10	3 x 32	0,457
120C1200	100	12	3 x 32	0,457
120C1400	100	14	3,5 x 45	0,458
120C1600	100	16	3,5 x 45	0,458
120C1800	100	18	4,5 x 60	0,522
120C2000	100	20	4,5 x 60	0,584
120C2200	100	22	4,5 x 60	0,602
120C2500	100	25	5 x 70	0,719
120C2800	100	28	5 x 70	0,720
120C3200	100	32	5 x 70	0,721

Art. 121

COLLARINO DOPPIO IN NYLON PER TUBO IN RAME
DOUBLE COPPER PIPE CLAMP IN POLYAMMIDE

M Nylon

 Bianco

 Resistenza ai raggi ultravioletti

 - 40° + 80°

 Buste PLT:
10 collari, 10 viti

 Scatole di cartone

CODE	CONF.	MISURA Ø mm	VITE Ø mm	€
121C1000	100	10	3 x 32	0,606
121C1200	100	12	3 x 32	0,606
121C1400	100	14	3,5 x 45	0,606
121C1500	100	15	3,5 x 45	0,606
121C1600	100	16	3,5 x 45	0,606
121C1800	100	18	4,5 x 60	0,724
121C2000	100	20	4,5 x 60	0,747
121C2200	100	22	4,5 x 60	0,780
121C2400	100	24	5 x 70	0,934
121C2600	100	26	5 x 70	0,934
121C2800	100	28	5 x 70	0,935

Art. 122

SOLO COLLARE FERMATUBO ELETTROSALDATO
ELECTROWELTED PIPE CLAMP WITH M8 NUT

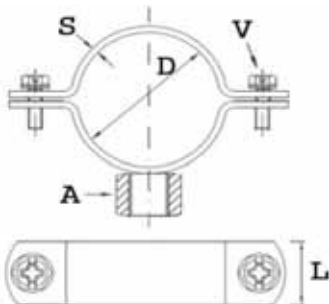

- M** Acciaio al Carbonio
- N** Zincati bianchi
- V** viti laterali 6 x 20
spacco cacciavite a stella



Buste PLT: 2 collari, 4 viti esagonali 6x20
Scatole di cartone

CODE	CONF.	D Ø	L x S	A mm	R taglio	R	traz	€
122C3800	100	3/8"	20 x 2,5	8	50	100		0,698
122C1200	100	1/2"	20 x 2,5	8	50	100		0,731
122C3400	100	3/4"	20 x 2,5	8	60	125		0,788
122C1000	100	1"	20 x 2,5	8	60	125		0,814
122C1140	100	1.1/4"	20 x 2,5	8	60	125		0,887
122C1120	100	1.1/2"	20 x 2,5	8	60	125		0,936
122C2000	50	2"	20 x 2,5	8	60	125		1,009
122C2120	50	2.1/2"	20 x 2,5	8	75	150		1,465
122C3000	30	3"	20 x 2,5	8	75	150		1,575
122C4000	30	4"	20 x 2,5	8	75	150		1,777

Art. 123B

COLLARE ELETTROSALDATO COMPLETO DI TASSELLO BLOCK
ELECTROWELTED COMPLETE PIPE CLAMP WITH "BLOCK" PLUG

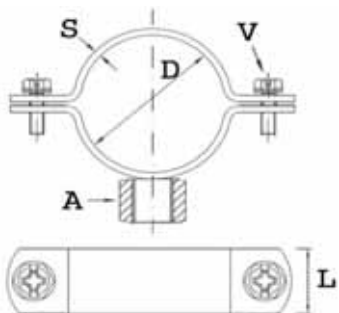

- M** Acciaio al Carbonio
- N** Zincati bianchi
- V** viti laterali 6 x 20
spacco cacciavite a stella



Buste PLT: 2 collari, 2 viti doppio filetto,
2 dadi, 2 tasselli block, 4 viti esagonali 6x20
Scatole di cartone

CODE	CONF.	D Ø	L x S	A mm	PERNO M mm	TASSELLO mm	R taglio	R	traz	€
123B3800	100	3/8"	20 x 2,5	8	8 x 90	10 x 50	50	100		0,917
123B1200	100	1/2"	20 x 2,5	8	8 x 90	10 x 50	50	100		0,949
123B3400	100	3/4"	20 x 2,5	8	8 x 90	10 x 50	60	125		1,004
123B1000	100	1"	20 x 2,5	8	8 x 90	10 x 50	60	125		1,030
123B1140	100	1.1/4"	20 x 2,5	8	8 x 90	10 x 50	60	125		1,101
123B1120	100	1.1/2"	20 x 2,5	8	8 x 90	10 x 50	60	125		1,149
123B2000	50	2"	20 x 2,5	8	8 x 90	10 x 50	60	125		1,221
123B2120	50	2.1/2"	20 x 2,5	8	8 x 90	10 x 50	75	150		1,665
123B3000	30	3"	20 x 2,5	8	8 x 90	10 x 50	75	150		1,773
123B4000	30	4"	20 x 2,5	8	8 x 90	10 x 50	75	150		1,956

Art. 124

SOLO COLLARE INOX CON DADO SALDATO

STAINLESS STEEL PIPE CLAMP WITH NUT

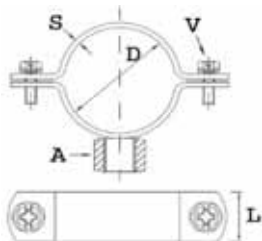

- M** Acciaio INOX
Z Zincati bianchi
V viti laterali 6 x 20
 spacco cacciavite a stella

- B** Buste PLT: 2 collari, 4 viti esagonali 6x20
S Scatole di cartone

CODE	CONF.	D Ø	L x S	A mm	R taglio	R	traz	€
124C1200	100	1/2"	20 x 2,5	8	50	100		2,921
124C3400	100	3/4"	20 x 2,5	8	60	125		3,112
124C1000	100	1"	20 x 2,5	8	60	125		3,261
124C1140	100	1.1/4"	20 x 2,5	8	60	125		3,535
124C1120	100	1.1/2"	20 x 2,5	8	60	125		3,807
124C2000	50	2"	20 x 2,5	8	60	125		4,408
124C2120	50	2.1/2"	30 x 2,5	10	75	150		7,685
124C3000	30	3"	30 x 2,5	10	75	150		8,311
124C4000	30	4"	30 x 2,5	10	75	150		9,295
124C5000	30	5"	30 x 2,5	10	75	150	a richiesta	
124C6000	30	6"	30 x 2,5	10	75	150	a richiesta	

I prezzi possono subire variazioni in funzione dell'andamento delle materie prime

Art. 125

COLLARE FERMATUBO INOX COMPLETO

STAINLESS INOX STEEL PIPE CLAMP COMPLETE

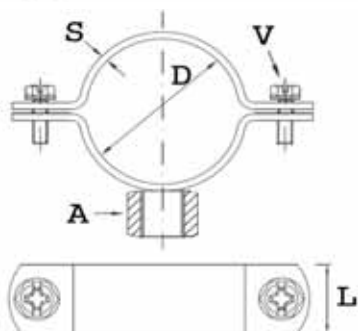

- M** Acciaio INOX
Z Zincati bianchi
V viti laterali 6 x 20
 spacco cacciavite a stella

- B** Buste PLT: 2 collari, 2 viti doppio filetto,
2 dadi, 2 tasselli, 4 viti esagonali 6x20
S Scatole di cartone

CODE	CONF.	D Ø	L x S	A mm	PERNO M mm	TASSELLO mm	R taglio	R	traz	€
125B1200	100	1/2"	20 x 2,5	8	8 x 90	10 x 50	50	100		4,496
125B3400	100	3/4"	20 x 2,5	8	8 x 90	10 x 50	60	125		4,693
125B1000	100	1"	20 x 2,5	8	8 x 90	10 x 50	60	125		4,838
125B1140	100	1.1/4"	20 x 2,5	8	8 x 90	10 x 50	60	125		5,104
125B1120	100	1.1/2"	20 x 2,5	8	8 x 90	10 x 50	60	125		5,383
125B2000	50	2"	20 x 2,5	8	8 x 90	10 x 50	60	125		5,984
125B2120	50	2.1/2"	30 x 2,5	10	10 x 120	12 x 60	75	150		11,450
125B3000	30	3"	30 x 2,5	10	10 x 120	12 x 60	75	150		12,084
125B4000	30	4"	30 x 2,5	10	10 x 120	12 x 60	75	150		13,073
125B5000	30	5"	30 x 2,5	10	10 x 120	12 x 60	75	150	a richiesta	
125B6000	30	6"	30 x 2,5	10	10 x 120	12 x 60	75	150	a richiesta	

I prezzi possono subire variazioni in funzione dell'andamento delle materie prime

Art. 126 COLLARE INOX PER CANNE FUMARIE STAINLESS STEEL PIPE CLAMP FOR FLUES



M Acciaio INOX
V viti laterali 6 x 20
spacco cacciavite a stella

Buste PLT: 2 collari, 2 viti doppio filetto, 2 dadi, 2 tasselli, 4 viti esagonali 6x20

Scatole di cartone

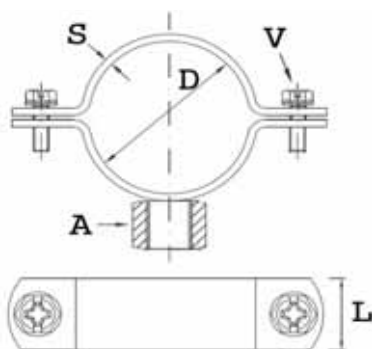

CODE	CONF.	D Ø mm	L x S	A mm	PERNO M mm	TASSELLO Ø mm	R taglio	R	traz	€
126B0800	50	80	30 x 1,5	8	8 x 90	10 x 50	50	100		7,227
126B0950	50	95	30 x 1,5	8	8 x 90	10 x 50	50	100		7,714
126B1000	50	100	30 x 1,5	8	8 x 90	10 x 50	50	100		8,040
126B1150	50	115	30 x 1,5	8	8 x 90	10 x 50	50	100		8,535
126B1200	50	120	30 x 1,5	8	8 x 90	10 x 50	50	100		8,681
126B1300	50	130	30 x 1,5	8	8 x 90	10 x 50	50	100		9,014
126B1400	50	140	30 x 1,5	8	8 x 90	10 x 50	50	100		9,347
126B1500	50	150	30 x 1,5	8	8 x 90	10 x 50	50	100		9,674
126B1600	50	160	30 x 1,5	8	8 x 90	10 x 50	50	100		10,013
126B1800	30	180	30 x 1,5	8	8 x 90	10 x 50	50	100		10,801
126B2000	30	200	30 x 1,5	8	8 x 90	10 x 50	50	100		11,456
126B2200	30	220	30 x 1,5	8	8 x 90	10 x 50	50	100		12,087
126B2500	20	250	30 x 1,5	8	8 x 90	10 x 50	50	100		13,223
126B3000	20	300	30 x 1,5	8	8 x 90	10 x 50	50	100		14,998
126B3150	20	315	30 x 1,5	8	8 x 90	10 x 50	50	100		17,085

I prezzi possono subire variazioni in funzione dell'andamento delle materie prime

Art. 128 COLLARE VERNICIATO TASSELLO DOPPIO PER CANNE FUMARIE PAINTED WHITE COMPLETE PIPE CLAMP WITH STRONG PLUG FOR FLUES

- Tassello a doppia espansione con boccola di ottone e perno a filettatura metrica



M Acciaio al Carbonio
Zincati e verniciati bianchi / neri / marroni
V Viti laterali 5 x 25

Buste PLT: 1 collare, 2 dadi, 2 viti, 1 perno, 1 borchia copriforo, 1 tassello

Scatole di cartone

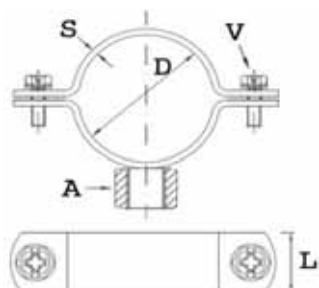

VERNICIATI BIANCHI

Ral 9010

CODE	CONF.	D Ø mm	L x S	A mm	PERNO M mm	TASSELLO Ø mm	R taglio	R	traz	€
128C6000	50	60	25 x 1,5	8	8 x 200	12 x 75	30	60		3,924
128C7000	50	70	25 x 1,5	8	8 x 200	12 x 75	30	60		5,688
128C8000	50	80	25 x 1,5	8	8 x 200	12 x 75	30	60		5,863
128C1000	50	100	25 x 1,5	8	8 x 200	12 x 75	30	60		6,036
128C1100	30	110	28 x 1,5	8	8 x 200	12 x 75	30	60		6,108
128C1200	30	120	28 x 1,5	8	8 x 200	12 x 75	30	60		6,180
128C1300	20	130	28 x 1,5	8	8 x 200	12 x 75	30	60		6,252
128C1400	20	140	28 x 1,5	8	8 x 200	12 x 75	30	60		7,070
128C1500	20	150	28 x 1,5	8	8 x 200	12 x 75	30	60		7,520
128C2000	20	200	28 x 1,5	8	8 x 200	12 x 75	30	60		8,332
128C2500	20	250	28 x 1,5	8	8 x 200	12 x 75	30	60		9,037
128C3000	20	300	28 x 1,5	8	8 x 200	12 x 75	30	60		9,314

VERNICIATI NERI

Ral 9005

128C800N	50	80	28 x 1,5	8	8 x 200	12 x 75	30	60		6,775
128C100N	50	100	28 x 1,5	8	8 x 200	12 x 75	30	60		6,975

VERNICIATI MARRONE

Ral 8017

128C80MR	50	80	28 x 1,5	8	8 x 200	12 x 75	30	60		6,775
128C10MR	50	100	28 x 1,5	8	8 x 200	12 x 75	30	60		6,975

Art. 128Z

COLLARE ZINCATO COMPLETO PER CANNE FUMARIE
GALVANIZED COMPLETE PIPE CLAMP FOR FLUES

- M** Acciaio al Carbonio
Zincati bianchi
- V** viti laterali 6 x 20
spacco cacciavite a stella

- Buste PLT: 1 collare, 1 dado, 2 viti esagonali 6x20, 1 tassello, 1 vite doppio filetto
- Scatole di cartone

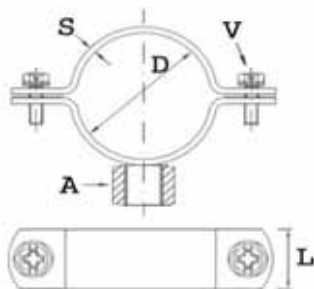

CODE	CONF.	D Ø mm	L x S	A mm	PERNO M mm	TASSELLO Ø mm	R taglio	R	traz	€
128B8000	20	80	30 x 1,5	8	8 x 90	10 x 50	50	100		3,459
128B1000	20	100	30 x 1,5	8	8 x 90	10 x 50	50	100		3,624
128B1100	20	110	30 x 1,5	8	8 x 90	10 x 50	50	100		3,694
128B1150	20	115	30 x 1,5	8	8 x 90	10 x 50	50	100		3,733
128B1200	20	120	30 x 1,5	8	8 x 90	10 x 50	50	100		3,762
128B1250	20	125	30 x 1,5	8	8 x 90	10 x 50	50	100		3,802
128B1300	20	130	30 x 1,5	8	8 x 90	10 x 50	50	100		3,832
128B1400	20	140	30 x 1,5	8	8 x 90	10 x 50	50	100		3,914
128B1500	20	150	30 x 1,5	8	8 x 90	10 x 50	50	100		3,984
128B1600	20	160	30 x 1,5	8	8 x 90	10 x 50	50	100		4,052
128B1800	20	180	30 x 1,5	8	8 x 90	10 x 50	50	100		4,225
128B2000	20	200	30 x 1,5	8	8 x 90	10 x 50	50	100		4,376
128B2200	10	220	30 x 1,5	8	8 x 90	10 x 50	50	100		4,515
128B2500	10	250	30 x 1,5	8	8 x 90	10 x 50	50	100		4,760
128B3000	10	300	30 x 1,5	8	8 x 90	10 x 50	50	100		5,460
128B3500	10	350	30 x 1,5	8	8 x 90	10 x 50	50	100		5,842
128B4000	10	400	30 x 1,5	8	8 x 90	10 x 50	50	100		6,492

Art. 106MTD

VITE METRICA E TASSELLO A DOPPIA ESPANSIONE
METRIC SCREW AND DOUBLE EXPANSION PLUG

Adatta per fissare a muro qualsiasi oggetto e collari.



- M** Acciaio al Carbonio
Zincata bianca, filetto metrico

- Buste PLT - 1 vite metrica, 1 dado M8, 1 tassello, 1 rondella
- Scatola cartone

CODE	CONF.	TYPE	LUNGH. MM	TASSELLO	Ø mm	DADO	RONDELLA	€
106MTD00	100	M8	200	12 x 70		M8	Ø 16	1,636
106MTD10	100	M10	200	14 x 75		M10	Ø 20	1,964

Art. 129
COLLARE PER PLUVIALI COMPLETO
COMPLETE PIPE CLAMP FOR GUTTERS

Adatti anche per canne fumarie

M Lamiera

Verniciati / Zincati / Rame

V viti laterali 6 x 20
spacco cacciavite a stella

 Buste PLT: 2 collari, 2 tasselli, 2 perni M 8x90,
2 dadi M 6, 4 viti esagonali 6x20

Scatole di cartone



CODE	CONF.	D Ø mm	L mm	S mm	V Ø mm	PERNO mm	M	TASS Ø mm	COLORE	€
ZINCATI										
129BZ600	100	60	20	0,6	6x20	8 x 80		10 x 50	zincato	1,301
129BZ750	100	75	20	0,6	6x20	8 x 80		10 x 50	zincato	1,306
129BZ800	100	80	20	0,6	6x20	8 x 80		10 x 50	zincato	1,308
129BZ900	100	90	20	0,6	6x20	8 x 80		10 x 50	zincato	1,354
129BZ100	100	100	20	0,6	6x20	8 x 80		10 x 50	zincato	1,354
129BZ110	100	110	20	0,6	6x20	8 x 80		10 x 50	zincato	1,445
129BZ120	100	120	20	0,6	6x20	8 x 80		10 x 50	zincato	1,450
129BZ125	100	125	20	0,6	6x20	8 x 80		10 x 50	zincato	1,455
129BZ140	100	140	20	0,9	6x20	8 x 80		10 x 50	zincato	3,122
129BZ150	100	150	20	0,9	6x20	8 x 80		10 x 50	zincato	3,734
129BZ160	100	160	20	0,9	6x20	8 x 80		10 x 50	zincato	3,734
129BZ200	100	200	20	0,9	6x20	8 x 80		10 x 50	zincato	4,069
VERNICIATI										
129BV600	100	60	20	0,6	6x20	8 x 80		10 x 50	testa moro	1,521
129BV750	100	75	20	0,6	6x20	8 x 80		10 x 50	testa moro	1,525
129BV800	100	80	20	0,6	6x20	8 x 80		10 x 50	testa moro	1,527
129BV900	100	90	20	0,6	6x20	8 x 80		10 x 50	testa moro	1,613
129BV100	100	100	20	0,6	6x20	8 x 80		10 x 50	testa moro	1,614
129BV110	100	110	20	0,6	6x20	8 x 80		10 x 50	testa moro	1,745
129BV120	100	120	20	0,6	6x20	8 x 80		10 x 50	testa moro	1,750
129BV125	100	125	20	0,6	6x20	8 x 80		10 x 50	testa moro	1,752
RAME										
129BR600	100	60	20	0,6	6x20	8 x 80		10 x 50	rame	4,203
129BR750	100	75	20	0,6	6x20	8 x 80		10 x 50	rame	4,208
129BR800	100	80	20	0,6	6x20	8 x 80		10 x 50	rame	4,210
129BR900	100	90	20	0,6	6x20	8 x 80		10 x 50	rame	4,759
129BR100	100	100	20	0,6	6x20	8 x 80		10 x 50	rame	4,761
129BR110	100	110	20	0,6	6x20	8 x 80		10 x 50	rame	5,524
129BR120	100	120	20	0,6	6x20	8 x 80		10 x 50	rame	5,529
129BR125	100	125	20	0,6	6x20	8 x 80		10 x 50	rame	5,531

Art. 130FAST SOLO COLLARE ISOFONICO A CHIUSURA RAPIDA

ISOPHONIC FAST PIPE CLAMP



- M** Acciaio al Carbonio
Gomma: EPDM nera
- Zincati bianchi con gomma nera
- N** DIN 4109
- V** vite laterale 5x25
spacco cacciavite stella

- Buste PLT: 2 collari, 1 vite esagonale 5 x 25
con spacco cacciavite a stella
- Scatole di cartone
- 40°
+ 100°

CODE	CONF.	D Ø	D mm	L x S	A mm	R taglio	R	traz	€
130F1400	100	1/4"	12 14	20X1,25	8-10	30	60		1,619
130F3800	100	3/8"	15 19	20X1,25	8-10	30	60		1,605
130F1200	100	1/2"	20 23	20X1,25	8-10	30	60		1,695
130F3400	100	3/4"	25 28	20X1,25	8-10	30	60		1,815
130F1000	100	1"	32 35	20X1,25	8-10	30	60		1,912
130F1140	100	1.1/4"	40 43	20X1,25	8-10	30	60		2,081
130F1120	100	1.1/2"	44 49	20X1,25	8-10	30	60		2,157
130F5400	100		50 55	20X1,25	8-10	30	60		2,342
130F2000	50	2"	57 61	20X1,25	8-10	30	60		2,598
130F6000	50		63 67	20X1,25	8-10	30	60		2,817
130F2120	50	2.1/2"	74 80	20X1,25	8-10	30	60		3,246
130F3000	30	3"	90 93	20X1,50	8-10	50	100		3,483
130F4000	30	4"	108 114	20X1,50	8-10	50	100		4,510

Art. 130 SOLO COLLARE ISOFONICO

ISOPHONIC PIPE CLAMP



- M** Acciaio al Carbonio
Gomma: EPDM nera
- Zincati bianchi con gomma nera
- N** DIN 4109
- V** viti laterali 6 x 20
spacco cacciavite a stella

- Buste PLT: 2 collari, 4 viti esagonali 6x20
- Scatole di cartone
- 40°
+ 100°

CODE	CONF.	D Ø	D mm	L x S	A mm	R taglio	R	traz	€
130C3800	100	3/8"	15-19	20 x 2	8-10	50	100		1,750
130C1200	100	1/2"	20-23	20 x 2	8-10	50	100		1,800
130C3400	100	3/4"	25-28	20 x 2	8-10	50	100		1,898
130C1000	100	1"	32-35	20 x 2	8-10	50	100		2,096
130C1140	100	1.1/4"	40-43	20 x 2	8-10	50	100		2,339
130C1120	100	1.1/2"	44-49	20 x 2	8-10	50	100		2,598
130C5400	100		50-55	20 x 2	8-10	50	100		2,683
130C2000	50	2"	57-61	20 x 2	8-10	50	100		3,114
130C7000	50		70-73	20 x 2	8-10	50	100		3,560
130C2120	50	2.1/2"	74-80	20 x 2	8-10	50	100		3,761
130C8300	50		83	20 x 2	8-10	50	100		4,204
130C3000	30	3"	83-91	20 x 2	8-10	50	100		4,209
130C3120	30	3.1/2"	101-106	20 x 2	8-10	50	100		4,709
130C1100	30		108-113	20 x 2	8-10	50	100		5,198
130C4000	30	4"	114-116	20 x 2	8-10	50	100		6,367
130C1250	20		123-128	20 x 2	8-10	50	100		7,365
130C5000	20	5"	137-142	20 x 2	8-10	50	100		8,375
130C6000	20	6"	159-167	20 x 2	8-10	50	100		10,143
130C2001	20		200-206	20 x 2	8-10	50	100		13,653
130C8000	20	8"	210-219	20 x 2	8-10	50	100		14,876
130C2500	20		250-255	20 x 2,5	M16	50	100	a richiesta	
130C3001	20		300	35 x 4	M16	50	100	a richiesta	
130C3150	20		315-320	35 x 4	M16	50	100	a richiesta	

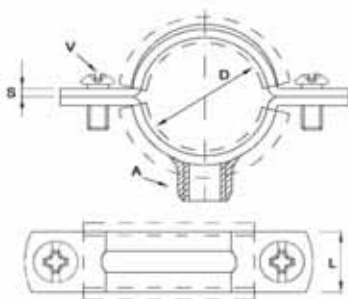



Art. 131

COLLARE ISOFONICO COMPLETO
COMPLETE ISOPHONIC PIPE CLAMP



- M** Acciaio Carbonio
EPDM nera
-  Zincati bianchi con gomma nera
- N** DIN 4109
- V** viti laterali 6 x 20
spacco cacciavite a stella

-  Buste PLT: 2 collari, 2 tasselli, 2 dadi, 2 viti doppio filetto, 4 viti esagonali 6x20
-  Scatole di cartone
-  - 40°
+ 100°

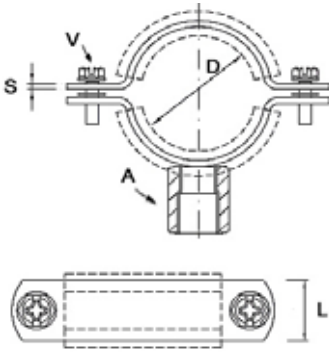

CODE	CONF.	D Ø	A mm	L x S	PERNO M mm	TASSELLO Ø mm	R taglio	R	traz	€
131B3800	100	3/8"	8-10	20 x 1,5	8 x 90	10x50	50	100		1,999
131B1200	100	1/2"	8-10	20 x 1,5	8 x 90	10x50	50	100		2,023
131B3400	100	3/4"	8-10	20 x 1,5	8 x 90	10x50	50	100		2,151
131B1000	100	1"	8-10	20 x 1,5	8 x 90	10x50	50	100		2,349
131B1140	100	1.1/4"	8-10	20 x 1,5	8 x 90	10x50	50	100		2,445
131B1120	100	1.1/2"	8-10	20 x 1,5	8 x 90	10x50	50	100		2,700
131B5400	100	54	8-10	20 x 2	8 x 90	10x50	50	100		2,768
131B2000	50	2"	8-10	20 x 2	8 x 90	10x50	50	100		3,182
131B7000	50	70	8-10	20 x 2	8 x 90	10x50	50	100		4,601
131B2120	50	2.1/2"	8-10	20 x 2	8 x 90	10x50	50	100		3,799
131B8300	50	83	8-10	20 x 2	8 x 90	10x50	50	100		4,226
131B3000	30	3"	8-10	20 x 2	8 x 90	10x50	50	100		4,228
131B3120	30	3.1/2"	8-10	20 x 2	8 x 90	10x50	50	100		4,709
131B1100	30	110	8-10	20 x 2,5	8 x 90	10x50	50	100		5,176
131B4000	30	4"	8-10	20 x 2,5	8 x 90	10x50	50	100		6,750
131B1250	20	125	8-10	20 x 2,5	10 x 120	12x60	50	100		7,235
131B5000	20	5"	8-10	20 x 2,5	10 x 120	12x60	50	100		8,196
131B6000	20	6"	8-10	20 x 2,5	10 x 120	12x60	50	100		9,882
131B2001	20	200	8-10	20 x 2,5	10 x 120	12x60	50	100		13,228
131B8000	20	8"	8-10	20 x 2,5	10 x 120	12x60	50	100		14,384
131B2500	20	250	8-10	20 x 2,5	10 x 120	12x60	50	100		a richiesta
131B3001	20	300	8-10	20 x 2,5	10 x 120	12x60	50	100		a richiesta
131B3150	20	315	8-10	20 x 2,5	10 x 120	12x60	50	100		a richiesta

Art. 130P

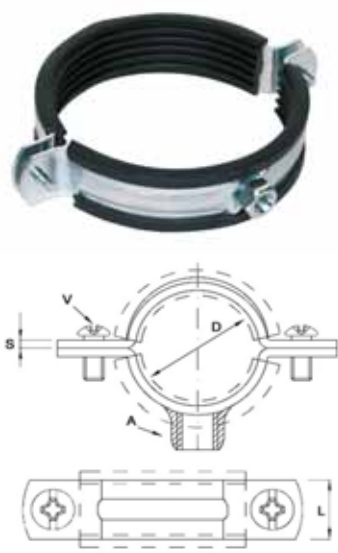
SOLO COLLARE ISOFONICO PESANTE TUBO PVC
HEAVY ISOPHONIC PIPE CLAMP

- M** Acciaio al Carbonio
EPDM nera
- Zincati bianchi con gomma nera
- N** DIN 4109
- V** Viti laterali 10 x 40 spacco
cacciavite a stella

- Buste PLT: 2 collari,
4 viti esagonali 10 x 40
- Scatole di cartone
- 40°
+ 100°

CODE	CONF.	D Ø	D mm	L x S	A mm	R taglio	R	traz	€
130P1000	50	1"	31 36	25 x 3	M8 M10	80	160		9,536
130P1140	50	1"1/4	38 45	25 x 3	M8 M10	80	160		9,903
130P1120	50	1"1/2	47 51	25 x 3	M8 M10	80	160		10,279
130P5500	50		53 57	25 x 3	M8 M10	80	160		10,546
130P2000	25	2"	58 64	25 x 3	M8 M10	80	160		10,691
130P2120	25	2"1/2	72 78	30 x 3	M10 M12	80	160		17,398
130P3000	25	3"	84 90	30 x 3	M10 M12	80	160		17,803
130P4000	10	4"	108 114	30 x 3	M10 M12	100	200		18,741
130P1200	10		120 125	35 x 4	M10 M12	100	200		30,460
130P5000	10	5"	137 142	35 x 4	M16	100	200		30,504
130P1600	10		158 163	35 x 4	M16	100	200		31,687
130P6000	10	6"	164 168	35 x 4	M16	100	200		35,498
130P0200	10		198 203	35 x 4	M16	150	300		39,519
130P2100	10		207 213	35 x 4	M16	150	300		47,736
130P8000	10	8"	219 223	35 x 4	M16	150	300		53,525
130P0250	10		250 255	35 x 4	M16	150	300	a richiesta	
130P0100	10	10"	270 275	35 x 4	M16	150	300	a richiesta	
130P0300	10		300	35 x 4	M16	150	300	a richiesta	
130P3150	10	12"	315 320	35 x 4	M16	150	300	a richiesta	
130P3600	10	14"	355 360	35 x 4	M16	150	300	a richiesta	

Art. 135

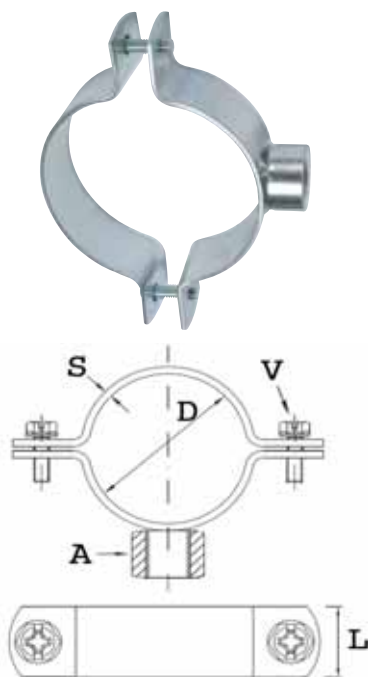
SOLO COLLARE PER TUBO PVC CON MANICOTTO
PIPE CLAMP FOR PVC PIPES WITH Ø 1/2 SLEVE

- M** Acciaio al Carbonio
- Zincati bianchi
- V** Con attacco da 1/2 Viti laterali 6 x 20
attacco da 1" viti laterali 8 x 25

- Buste PLT: 2 collari, 4 viti esagonali 6x20
- Scatole di cartone

CODE	CONF.	D mm	L x S	A mm	R taglio	R	traz	€
135C4000	50	40	30 x 2,5	1/2"	100	200		3,137
135C5000	50	50	30 x 2,5	1/2"	100	200		3,275
135C6300	50	63	30 x 2,5	1/2"	100	200		3,456
135C7500	50	75	30 x 2,5	1/2"	100	200		3,592
135C8000	50	80	30 x 2,5	1/2"	100	200		3,682
135C9000	50	90	30 x 2,5	1/2"	100	200		3,816
135C1000	50	100	30 x 2,5	1/2"	100	200		3,952
135C1100	50	110	30 x 2,5	1/2"	100	200		4,086
135C1250	50	125	30 x 2,5	1/2"	100	200		4,267
135C1400	25	140	30 x 2,5	1/2"	100	200		4,706
135C1600	25	160	30 x 2,5	1/2"	100	200		4,988
135C2000	25	200	30 x 2,5	1/2"	100	200		8,017
135C2500	10	250	40 x 3,0	1"	100	200		8,393
135C3000	10	300	40 x 3,0	1"	100	200		8,673
135C3150	10	315	40 x 3,0	1"	100	200		9,325

Art. 136

SOLO COLLARE PER TUBO PVC CON DADO M10
PIPE CLAMP FOR PVC PIPES WITH M10 NUT

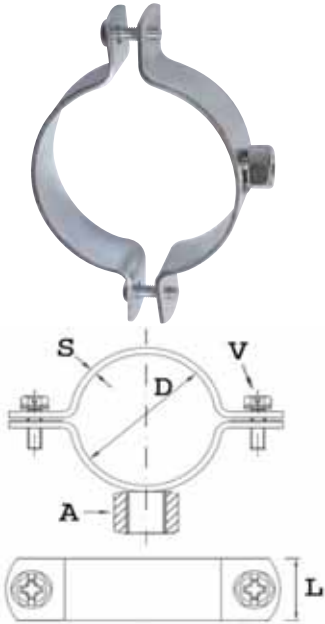

M Acciaio al Carbonio

Zincati bianchi

V Viti laterali 6 x 20
spacco cacciavite stella



Buste PLT: 2 collari, 4 viti esagonali 6x20

Scatole di cartone

CODE	CONF.	Pollici	D +/- 1 mm	L x S	A mm	R taglio	R	traz	€
136C4000	50		40	30 x 2,5	10	100	200		1,703
136C5000	50	1"1/2	50	30 x 2,5	10	100	200		1,841
136C6300	50	2"	63	30 x 2,5	10	100	200		2,027
136C7500	50	2"1/2	75	30 x 2,5	10	100	200		2,187
136C8000	50		80	30 x 2,5	10	100	200		2,253
136C9000	50	3"	90	30 x 2,5	10	100	200		2,387
136C1000	50		100	30 x 2,5	10	100	200		2,526
136C1100	50		110	30 x 2,5	10	100	200		2,671
136C0114	50	4"	114	30 x 2,5	10	100	200		2,875
136C1250	50		125	30 x 2,5	10	100	200		3,029
136C1400	25	5"	140	30 x 2,5	10	100	200		3,252
136C1600	25		160	30 x 2,5	10	100	200		3,942
136C2000	25		200	30 x 2,5	10	100			6,275
136C2500	25		250	30 x 2,5	10	100	200		7,627
136C3000	25		300	30 x 2,5	10	100	200		8,158
136C3150	25		315	30 x 2,5	10	100	200		9,080

Art. 137B

**COLLARE PER TUBO PVC COMPLETO
 CON TASSELLO BLOCK**
COMPLETE PIPE CLAMP FOR PVC PIPES WITH "BLOCK" PLUG

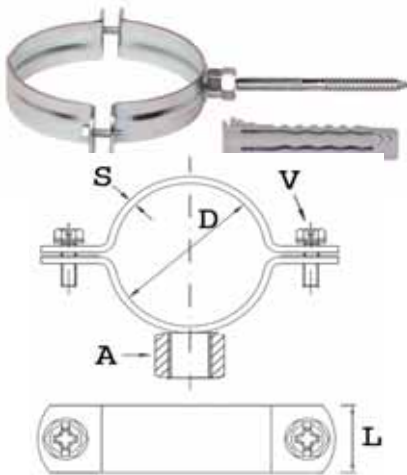

M Acciaio al Carbonio

Zincati bianchi

V Viti laterali 6 x 20
spacco cacciavite a stella



Buste PLT: 2 collari, 2 tasselli Block, 2 perni doppio filetto, 2 dadi, 4 viti esagonali 6x20 con spacco cacciavite a stella



Scatole di cartone

CODE	CONF.	D mm	L x S	A mm	PERNO M	TASSELLO Ø mm	R taglio	R	traz	€
137B4000	50	40	30 x 2,5	10	10x120	12x60	100	200		2,486
137B5000	50	50	30 x 2,5	10	10x120	12x60	100	200		2,642
137B6300	50	63 - 2"	30 x 2,5	10	10x120	12x60	100	200		2,841
137B7500	50	75 - 2"1/2	30 x 2,5	10	10x120	12x60	100	200		3,024
137B8000	50	80	30 x 2,5	10	10x120	12x60	100	200		3,105
137B9000	50	90 - 3"	30 x 2,5	10	10x120	12x60	100	200		3,251
137B1000	50	100	30 x 2,5	10	10x120	12x60	100	200		3,404
137B1100	50	110	30 x 2,5	10	10x120	12x60	100	200		3,585
137B1250	50	125	30 x 2,5	10	10x120	12x60	100	200		3,964
137B1400	25	140 - 5"	30 x 2,5	10	10x120	12x60	100	200		4,433
137B1600	25	160	30 x 2,5	10	10x120	12x60	100	200		5,257
137B1680	25	168 - 6"	30 x 2,5	10	10x120	12x60	100	200		5,474
137B2000	25	200	30 x 2,5	10	10x120	12x60	100	200		6,157
137B2500	25	250	30 x 2,5	10	10x120	12x60	100	200		8,339
137B3000	25	300	30 x 2,5	10	10x120	12x60	100	200		8,887
137B3150	25	315	30 x 2,5	10	10x120	12x60	100	200		9,974

Art. 138

GRAFFETTA
SINGLE FASTENING LIGHT BRACKET

M Acciaio al Carbonio
 Zincati bianchi

Sfusi
 Scatole di cartone

CODE	CONF.	MISURA Ø mm	A mm	B mm	C mm	D mm	SPESS mm	ASOLA mm	€
138C1000	100	10	10	16	11	29	1	4,5x6,5	0,068
138C1200	100	12	10	16	13	32	1	4,5x6,5	0,075
138C1400	100	14	10	16	15	32	1	4,5x6,5	0,075
138C1600	100	16	12	18	17	36	1	4,5x6,5	0,101
138C2000	100	20	12	18	21	39	1	4,5x6,5	0,097
138C2200	100	22	14	21	23	45	1	4,5x8	0,138
138C2500	100	25	14	21	26	46	1	4,5x8	0,144
138C2800	100	28	14	21	29	46	1	4,5x8	0,211
138C3200	100	32	16	22	33	50	1	4,5x8	0,318
138C4000	100	40	16	22	41	53	1	4,5x8	0,369
138C5000	100	50	16	24	51	60	1	4,5x8	0,899

Art. 139

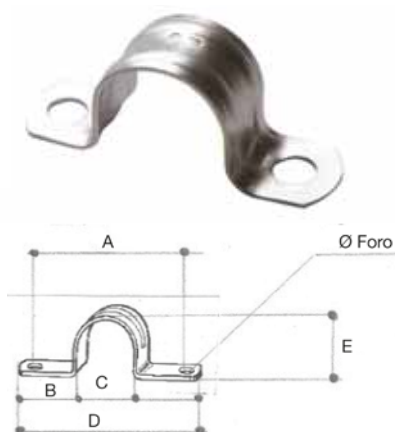
CAVALLOTTO
DOUBLE FASTENING LIGHT BRACKET

M Acciaio al Carbonio
 Zincati bianchi

Sfusi
 Scatole di cartone

CODE	CONF.	MISURA Ø mm	L mm	B mm	C mm	D mm	SPESS mm	ASOLA mm	€
139C1000	100	10	12,5	13	10	42	1,2	6,5x5	0,071
139C1200	100	12	12,5	14	13	45	1,2	6,5x5	0,080
139C1400	100	14	12,5	14	13	45	1,2	6,5x5	0,082
139C1600	100	16	12,5	15	16	49	1,2	6,5x5	0,098
139C2000	100	20	12,5	15	19	51	1,2	6,5x5	0,106
139C2200	100	22	12,5	18	22	61	1,2	6,5x5	0,142
139C2500	100	25	12,5	18	26	63	1,2	6,5x5	0,153
139C2800	100	28	12,5	18	28	67	1,2	6,5x5	0,167
139C3200	100	32	12,5	18	32	69	1,2	6,5x5	0,201
139C4000	100	40	12,5	18	40	78	1,2	6,5x5	0,225
139C5000	100	50	12,5	20	50	92	1,2	6,5x5	0,288

Art. 140 CAVALLOTTO A CRAVATTA "U" Bolt GALVANIZED STEEL BAR



M Acciaio al Carbonio
Zincati bianchi

Confezionati in scatola
con 2 dadi e 2 rondelle
Scatole di cartone

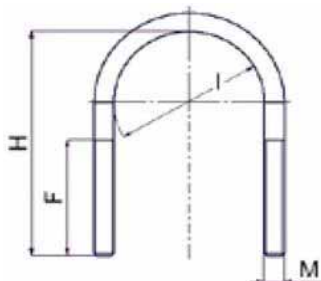

CODE	CONF.	I Ø	D mm	M M	F mm	H mm	RONDEL mm	DADO M	€
140C1200	100	1/2"	23,5	6	35	53	24	6	0,727
140C3400	100	3/4"	28	6	35	59	24	6	0,754
140C1000	100	1"	34	6	35	65	24	6	0,800
140C1140	50	1.1/4"	43,5	6	35	74	24	6	0,878
140C1120	50	1.1/2"	50	8	40	85	30	8	1,552
140C2000	50	2"	61	8	40	97	30	8	1,520
140C2120	50	2.1/2"	77	8	40	113	30	8	2,287
140C3000	50	3"	89	8	40	126	30	8	2,379
140C4000	50	4"	115	8	40	152	30	8	2,632
140C5000	50	5"	142	8	40	179	30	8	4,638
140C6001	50	6"	168	10	40	204	30	8	6,413
140C8001	50	8"	220	10	40	255	30	10	7,572

Art. 141 PROFILO IN GOMMA PER INSONORIZZAZIONE RUBBER PROFILE



M EPDM
Nero

Rotoli
Scatole di cartone

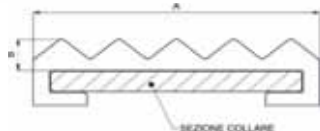

CODE	CONF.	A x B mm	ROTOLO m	€ / mt
141C2031	1	20 x 3	10	6,984
141C3051	1	30 x 3	10	7,780

Art. 142

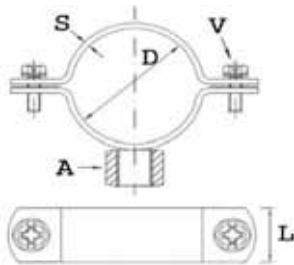
COLLARI TROPICALIZZATI
COMPLETE LIGHT PIPE CLAMP

- M** Acciaio al Carbonio
Z Zincatura tropicalizzata
V viti laterali 5 x 10

- Buste PLT - 10 collari, 20 viti,
10 perni, 10 dadi, 10 tasselli
 Scatole di cartone

CODE	CONF.	D mm	L x S	A M mm	PERNO M mm	TASSELLO Ø mm	R taglio	R	traz	€
142B1000	100	10	13 x 1,2	6	6 x 45	6 x 30	10	40	0,546	
142B1200	100	12	13 x 1,2	6	6 x 45	6 x 30	10	40	0,549	
142B1400	100	14/15	13 x 1,2	6	6 x 45	6 x 30	10	40	0,549	
142B1600	100	16	13 x 1,2	6	6 x 45	6 x 30	10	40	0,562	
142B1800	100	18	13 x 1,2	6	6 x 45	6 x 30	10	40	0,569	
142B2000	100	20	13 x 1,2	6	6 x 45	6 x 30	10	40	0,573	
142B2200	100	22	13 x 1,2	6	6 x 45	6 x 30	10	40	0,575	
142B2400	100	24	13 x 1,2	6	6 x 45	6 x 30	10	40	0,611	
142B2600	100	26	13 x 1,2	6	6 x 45	6 x 30	10	40	0,634	
142B2800	100	28	13 x 1,2	6	6 x 45	6 x 30	10	40	0,635	
142B3200	50	32	13 x 1,2	6	6 x 45	6 x 30	10	30	0,638	
142B3500	50	35	13 x 1,2	6	6 x 45	6 x 30	10	30	0,667	
142B4000	50	40	13 x 1,2	6	6 x 45	6 x 30	10	30	0,721	
142B4200	50	42	13 x 1,2	6	6 x 45	6 x 30	10	30	0,735	
142B5000	50	50	16 x 1,2	6	6 x 45	6 x 30	10	30	0,810	
142B6000	50	60	16 x 1,2	6	6 x 45	6 x 30	10	30	0,996	

Art. 143

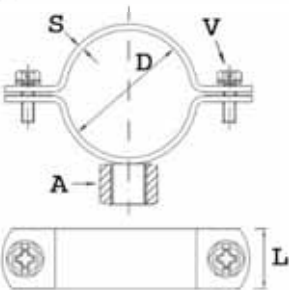
COLLARINI IN RAME
COMPLETE COPPER PIPE CLAMP

- M** Rame
V viti laterali 5 x 10

- Buste PLT: 10 collari,
10 tasselli, 10 perni e 20 viti
 Scatole di cartone

CODE	CONF.	D mm	L x S	A M mm	PERNO M mm	TASSELLO Ø mm	R taglio	R	traz	€
143B1000	100	10	13 x 1,2	6	6 x 45	6 x 30	10	40	1,696	
143B1200	100	12	13 x 1,2	6	6 x 45	6 x 30	10	40	1,696	
143B1400	100	14	13 x 1,2	6	6 x 45	6 x 30	10	40	1,697	
143B1600	100	15/16	13 x 1,2	6	6 x 45	6 x 30	10	40	1,786	
143B1800	100	18	13 x 1,2	6	6 x 45	6 x 30	10	40	1,841	
143B2200	100	22	13 x 1,2	6	6 x 45	6 x 30	10	40	1,913	
143B2800	100	28	13 x 1,2	6	6 x 45	6 x 30	10	40	2,084	
143B3500	50	35	13 x 1,2	6	6 x 45	6 x 30	10	40	2,301	
143B4200	50	42	16 x 1,2	6	6 x 45	6 x 30	10	40	2,707	
143B5400	50	54	16 x 1,2	6	6 x 45	6 x 30	10	40	3,589	

Art. 144

COLLARI PER IMPIANTI ANTINCENDIO SPRINKLER
SPRINKLER PIPE CLAMP



Collare per sostegno di tubi antincendio sprinkler

M Acciaio al Carbonio
 Zincata bianca

N Omologati FM
 Scatola di cartone



CODE	CONF.	D Ø	DN	D mm	L mm	S mm	DADO M	€
144C1000	100	1"	25	34	25	1,2	10	2,631
144C1140	100	1.1/4"	32	43	25	1,2	10	2,624
144C1120	100	1.1/2"	40	49	25	1,2	10	2,706
144C2000	100	2"	50	61	25	1,2	10	2,832
144C2120	100	2.1/2"	65	77	25	1,2	10	3,754
144C3000	50	3"	80	89	25	1,2	10	4,153
144C4000	25	4"	100	115	32	1,5	10	5,582
144C5000	25	5"	125	140	32	1,5	12	10,276
144C6000	25	6"	150	168	32	1,5	12	11,128
144C8000	25	8"	200	219	40	2	12	a richiesta

Art. 149

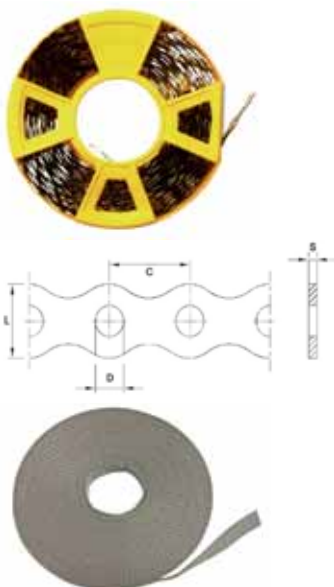
BANDELLA SOSTEGNO TUBAZIONI ZINCATA ED IN TESSUTO
SADDLE SUPPORTING THE PIPINGS



M Acciaio al Carbonio
 Zincata

 Rotoli in plastica
 Scatole di cartone

CODE		L mm	D mm	C mm	S mm	LUNGH. mt	€
149C1010	Zincata	12	5	12	0,8	10	9,339
149C1710	Zincata	17	7	12	0,8	10	10,700
149C2625	Zincata	26	8	12	1	25	36,825
149T1410	In tessuto	14			1	10	7,027



149T1410
 BANDELLA IN TESSUTO

Art. 171

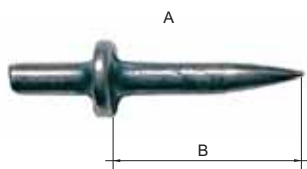
CHIODI IN ACCIAIO
STEEL NAIL



M Acciaio al Carbonio
 Zincati bianchi

 Buste PLT
 Scatole di cartone

CODE	CONF.	A	B	PESO gr	€
171CHI18	200	4	18	0,6	0,109
171CHI22	200	4	22	0,7	0,121

Art. 171P PUNZONE CON IMPUGNATURA NAIL-HOLDER GRIP



M Acciaio al Carbonio e plastica
Nero e zincato bianco

Sfuse
Scatole di cartone

CODE	CONF.	PESO gr	€
171MPU00	sfuse	500	74,411

Art. 150Q PIASTRA A MURO RETTANGOLARE RECTANGULAR PLATE



M Acciaio al Carbonio
Zincata bianca

Sfuse
Scatole di cartone

CODE	CONF.	L mm	A x S	ASOLE	Attacco	R	traz	€
150QM100	50	80	30 x 3	17x8,5	10	80	1,372	
150QMEZ0	50	80	30 x 3	17x8,5	1/2"	100	2,257	
150QM10G	50	120	40 x 4	19x11	10	110	2,603	
150QMEZG	50	120	40 x 4	19x11	1/2"	110	2,840	
150Q1POL	50	120	40 x 4	19x11	1"	110	8,123	

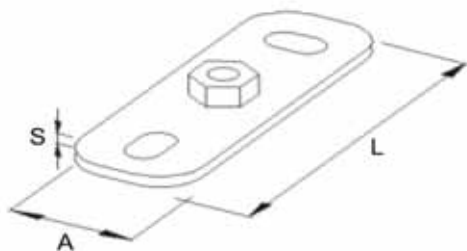

Art. 150 FLANGIA A MURO TONDA PORTACOLLARE CIRCULAR WALL-FITTING FLANGE TO SUPPORT CLAMPS



M Acciaio al Carbonio
Zincata bianca

Sfuse
Scatole di cartone

CODE	CONF.	D mm	S mm	ASOLE mm	Attacco	R	traz	€
150C1000	100	75	2	17 x 8,5	10	80	1,734	
150C1200	100	75	2	17 x 8,5	1/2"	100	2,642	



Art. 150A
RIDUZIONI PER FLANGE A MURO TONDA PORTACOLLARI
REDUCTION SPACERS FOR WALL-FITTING FLANGE TO SUPPORT CLAMPS

M Acciaio al Carbonio
 Zincata bianca

Sfuse
 Scatole di cartone

CODE	CONF.	FILETTO ESTERNO	FILETTO INTERNO	€
150AM800	100	1/2	M 8	1,906
150AM100	100	1/2	M 10	2,106

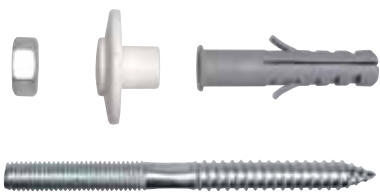
Art. 160
FISSAGGIO PER CASSETTE A PARETE
SPECIAL FIXING FOR WALL MOUNTED WATER-BOX

M Acciaio al Carbonio e nylon
 Zincata bianco

Buste PLT: 2 viti doppio filetto, 2 tasselli,
2 dadi in acciaio, 2 distanziatori
 Scatole di cartone

CODE	CONF.	KIT	PERNO mm	TASSELLO mm	BORCHIA mm	€ / CP
160C8900	50	2	8 x 90	10 x 60	37	0,765

Art. 161
CODETTE PER FISSAGGIO SCALDABAGNI
SPECIAL WALL FIXING FOR FISSING BETHROOM WATER HEATERS

M Acciaio al Carbonio e nylon
 Zincata bianco



Buste PLT: 2 viti a codetta, tasselli
 Scatole di cartone

CODE	CONF.	KIT	CODETTE mm	TASSELLO mm	€ / CP
161B8700	50	2	8 x 70	10 x 50	0,752
161B1080	50	2	10 x 80	12 x 60	1,074
161B1010	50	2	10 x 100	12 x 60	1,370
161B1012	50	2	10 x 120	12 x 60	1,828

Art. 163

BULLONI PER VASI E BIDET A PAVIMENTO
FIXING BOLTS FOR FITTING TOILET BOWLS AND BIDET TO FLOOR

M Acciaio AVP - Ottone -
Acciaio inox
Zincati o cromati

 Buste PLT: 4 viti di giunzione, 4 tasselli
4 dadi cromati, 4 boccole nylon
 Scatole di cartone



CODE	CONF.	PERNO mm	TASSELLO mm	BORCHIA mm	DADO M	€ / CF
163B6801	50	6 x 80 AVP	10 x 50	17	6	2,780
163B6802	50	6 x 80 ottone	10 x 50	17	6	4,451
163B6803	50	6 x 80 inox	10 x 50	17	6	5,162

I prezzi possono subire variazioni in funzione dell'andamento delle materie prime

Art. 166

STAFFA IN NYLON PER FISSAGGIO LATERALE VASI E BIDET
ABS BRACKETS FOR SIDE FITTING TOILET BOWLS AND BODET

M Nylon
Bianca



 Buste PLT: 2 tasselli, 4 viti, 2 staffe, 2 borchie,
2 tappi cromati
 Scatole di cartone

CODE	CONF.	KIT	€ / CP
166B7600	50	2	3,324

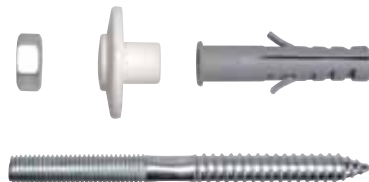
Art. 169

FISSALAVABO CON DADO ACCIAIO
FIXING ELEMENT FOR WASH BASIN (WITH STEEL NUT)

M Acciaio al Carbonio e nylon
Zincato bianco e nylon bianco

 Buste PLT: 2 tasselli, 2 boccole nylon,
2 dadi in acciaio, 2 viti di congiunzione
 Scatole di cartone

CODE	CONF.	KIT	Perno mm	TASSELLO mm	BORCHIA mm	€ / CP
169C8900	50	2	8 x 90	10 x 60	36	0,765
169C8100	50	2	8 x 100	10 x 60	36	0,778
169C1010	50	2	10 x 100	12 x 60	36	1,112
169C1012	50	2	10 x 120	12 x 60	36	1,228
169C1014	50	2	10 x 140	12 x 60	36	1,387
169C1018	50	2	10 x 180	12 x 60	36	1,631
169C1023	50	2	10 x 230	12 x 60	36	2,092